





Underground Railroad BOM - Month 11

Sail Boat



Fabric pieces needed

-  Fabric A - (2) 4 1/2" x 4 1/2" squares
-  Fabric B - (1) 4 1/2" x 4 1/2" square, (1) 3 1/2 x 6 1/2"
-  Fabric C - 12 1/2" x 3 1/2" rectangle
-  Background: (3) 4-1/2 x 4-1/2" squares
- (2) HST A and (1) HST B
- (4) 3 1/2 x 3 1/2" squares

Making 2-at-a-time Half Square Triangles (HST)

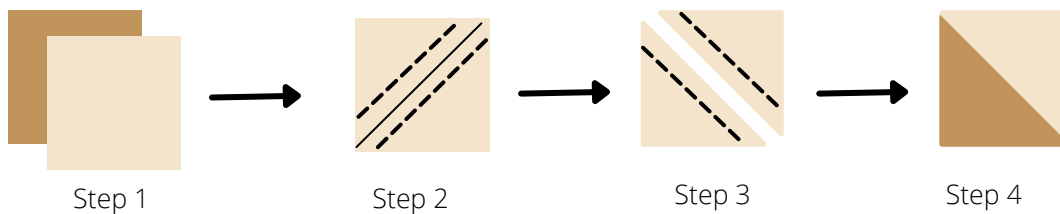

- Step 1 - Pair each Fabric A and B, 4 1/2" x 4 1/2" squares with a background 4 1/2" x 4 1/2" square.
- Step 2 - Draw a diagonal line from corner to corner on the wrong side of each 4 1/2" x 4 1/2" background square. With right sides together, stitch 1/4 inch from each side of the drawn line.
- Step 3 - Cut on the drawn line.
- Step 4 - Open and press. Trim each HST to 3 1/2" x 3 1/2".

Block Assembly Diagram

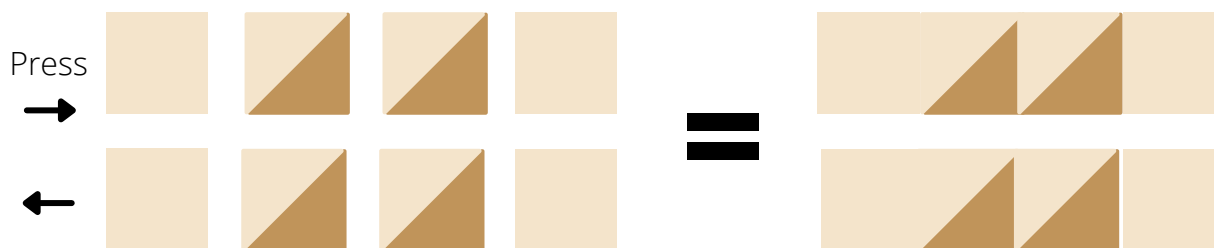

Fig. 1

1. Sew together the top two rows of block as shown in Fig. 1. Press each row in the direction of arrows.



Fig. 2

2 Sew together the third row of block as shown in Fig. 2 using two Fabric B HST and one Fabric B, 3 1/2" x 6 1/2" rectangle. Press in the direction of arrow.

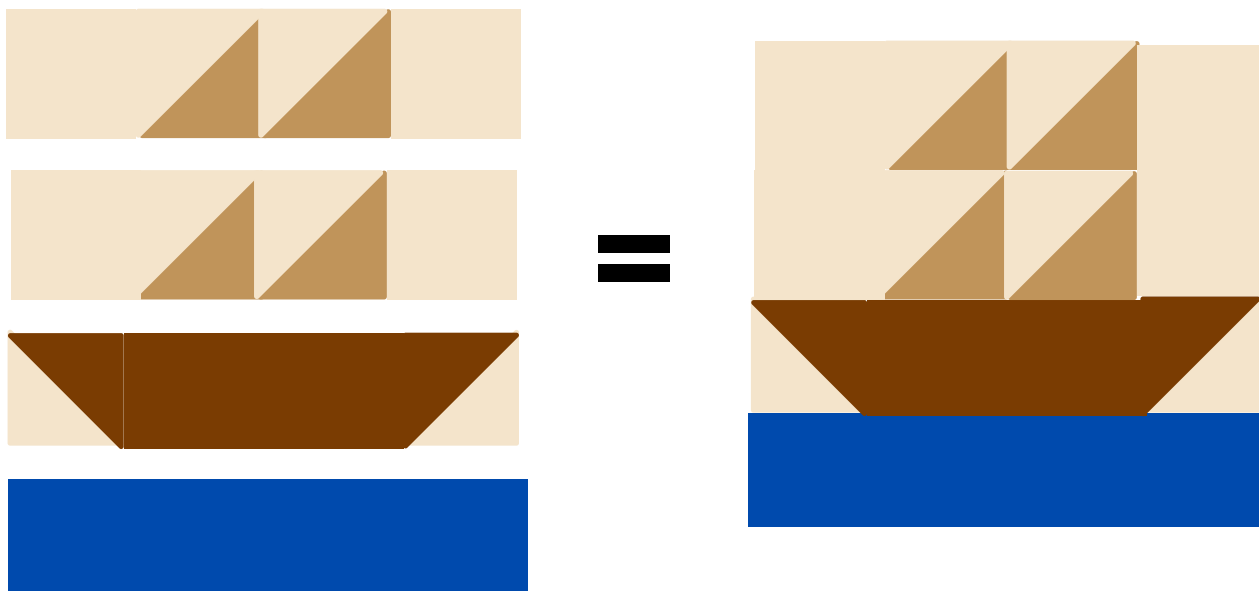

3. Sew rows together and press to complete your sailboat block.

